



Build-a-Blade

Custom blade servers you can design and build yourself

BB-ITX96 Blade Computing System

SAVE ENERGY

Build-a-Blade offers high density computing with very low power - this translates into operational savings in kilowatt hours, not only for the servers, but also for air conditioning, removing waste heat in server rooms - a win-win advantage.

SAVE INVESTMENTS

Unlike proprietary blade systems, we offer reusable blade trays. When your washer or dryer at home needs replacement, do you throw away your house to replace appliances inside? Of course not. Our blade chassis stays in place, you simply upgrade the appliances inside with the latest technology.

SAVE MONEY

Your ROI is high, and cost of ownership low, because when you need more computing power, you simply swap out widely available mainboards, processors, drives, etc. onto the reusable blade tray and put the blade tray back into the chassis. No waste, no re-racking, no hassle.



FEATURES

- Dramatically lower power consumption - operates on either AC or DC power
- Uses widely available and inexpensive industry standard parts
- Build it yourself or buy it fully pre-configured to your needs
- Fixed or hot-swap drives

BENEFITS

- Reusable chassis design - provides exceptional ROI/total cost of ownership
- Upgradeable and scalable in place
- Combine mixed computing configurations in a single chassis

APPLICATIONS

- ISP's, render farms, clouds
- Data acquisition, telecom systems
- Media rooms, signage clusters
- DC powered remote/mobile

Imagine a blade server you can build yourself or buy fully configured to your specs, but uses a third to a fifth of the power compared to conventional server solutions. This is what we offer, a system that is the first of its kind, so unique, it is patent-pending. The BB-ITX96 is a flexible blade chassis system designed around inexpensive and widely available industry standard Mini-ITX components offering a low power alternative (25 watts per blade or less) to expensive and proprietary commercial blade systems.

It offers long term ROI, far exceeding traditional blade systems and operates on either AC or DC power, making it suitable for remote or green applications. It features architecture that allows you to mix blade hardware configurations in a single chassis and is a scalable solution that can support small business needs, specialized OEM applications, digital signage clusters, media rooms, and server/rendering/computing/cloud farms.

The BB-ITX96 offers a unique solution for cooling and power consumption problems that plague server rooms and is a RoHS compliant product proudly designed and made in the USA! We offer starter kits for do-it-yourself blade systems as well as systems fully configured to your specifications, ready to run.



Build-a-BladeTM Patent Pending

| A division of ITWorks | 3008 Cohasset Rd | Chico, CA 95973 | 530-899-8434 | www.buildablade.com |



Build-a-Blade

Custom blade servers you can design and build yourself

CONFIGURABLE

Using any widely available industry standard Mini-ITX mainboard, CPU's from Atoms to i7 to Xeons, 2.5" disk drive, memory, and appropriate low height heatsink/fansink combination, you can configure the BB-ITX96 blade tray for any job!

REUSABLE

Keep up with processing and storage needs by simply swapping out new technology. Blades can be upgraded and re-used for years, improving your ROI.

TURNKEY SOLUTIONS

In addition to chassis with 1 blade starter kits, we offer fully loaded systems with 9 blades, optionally with mainboards, drives, and memory of your choice already installed and ready to run. Ask for a quote.

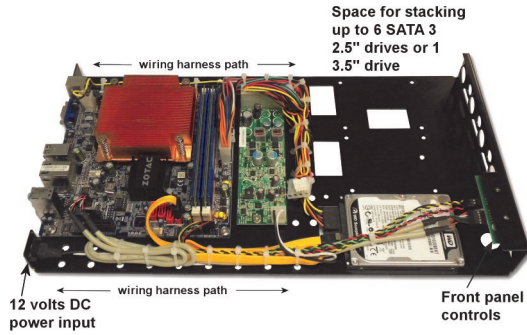

Fixed Mount Blade Tray System
with up to 6 drives per blade (w/ stacking rails)
(up to 54 drives per 6U chassis)

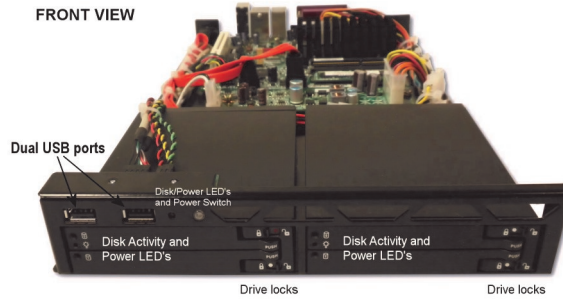

Hot Swap Blade Tray System
with 4x 2.5" SATA3 drives for BB-ITX96
(up to 36 drives per 6U chassis)



FEATURES

- Supports most standard Mini-ITX mainboards of 17x17cm
- Supports six 2.5" drives when used with stacking rails, or three without, single 3.5" drive
- Supports four hot-swap drives with optional hot-swap tray
- Blades include a 250 watt DC to DC ATX power converter
- Front blade switch/LED's for On/Off, Disk activity, Power
- Dual USB ports on blade front for servicing, thumbdrives
- Open frame design for easy service and upgrades
- Unrestricted front to rear air flow, long life fans with alarms
- Integrated wiring management
- Blades secured by single rear thumbscrew - allowing quick removal via hinged front door
- Easy to service air filter

System Specifications:

Chassis		
Blades	Up to 9 blades	Can operate with 1-9
Dimensions	15"Dx18.1"Wx10.5"H	6U rack height, 8 holes
Weight	30 pounds	unloaded
Power	12-14 volts DC 2.1A	Single rear coaxial plug
Color	Gentian blue front door	Black chassis box
Security	Locking front door	2 keys supplied
Alerting	Fan rotation and internal temperature 2 temperature probes	Front panel light flashes, audible alarm with mute button
Airflow	Eight 56.8 CFM hydro-wave fans	Total front to back airflow of 454.4 CFM
Blade tray		
Dimensions	14"D x9"W x1.5"H	Vertical rail mounted
Weight	3 pounds	With wiring/power
Power	12-14 volts DC (120 watts standard, 250 watts max)	Single rear coaxial plug, 120 watt AC-DC supply standard
Front panel	Combined power/LED switch, disk activity LED, wiring	Dual USB 2.0 ports with 550mm USB header cables

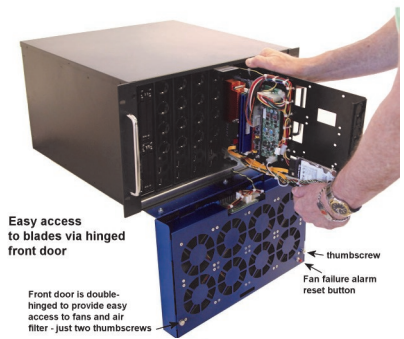

Build-a-Blade™

Patent Pending

| A division of ITWorks | 3008 Cohasset Rd | Chico, CA 95973 | 530-899-8434 | www.buildablade.com |